

PROPERTY MAP
FOR
GRILSE PARTNERS & ROBERT SEARLES
PARCEL NOS. 09-001514 & 09-001539
 SITUATED IN THE TOWNSHIP OF CHARDON, COUNTY OF GEauga AND STATE OF OHIO AND KNOWN AS BEING PART OF ORIGINAL CHARDON TOWNSHIP LOT NO. 2 IN SECTION NO. 1, TRACT NO. 4

THE PURPOSE OF THIS PROPERTY PLAT IS TO SHOW THE 12.475 ACRES OF LAND, LABELED AS "LAND TO BE CONVEYED", PRESENTLY OWNED BY GRILSE PARTNERS AND BEING CONVEYED TO ROBERT SEARLES AS PART OF A LOT SPLIT AND CONSOLIDATION FORMING PARCELS "D", "E" AND "F". THE 12.475 ACRES PARCEL WILL NOT BE A NEWLY CREATED PARCEL, BUT IS JUST AN INTERMEDIATE STEP TO CONVEY THE LAND TO THE SEARLES', AFTER WHICH THE DEEDS FOR PARCELS "D", "E" AND "F" WILL BE FILED CREATING THE THREE NEW PARCELS.

CERTIFICATION:
 I hereby certify that the drawing hereon is a correct representation of a true and accurate survey made of the premises shown hereon; dimensions are expressed in feet and decimal parts thereof; the basis of bearings used is as established in the deed recorded in Volume 1836, Page 2483 of Geauga County Records; and monuments were found or set as indicated hereon;

Robert J. Smoltz
 Robert J. Smoltz
 Registered Surveyor No. 6763
 State of Ohio
 Date: 10/08/08

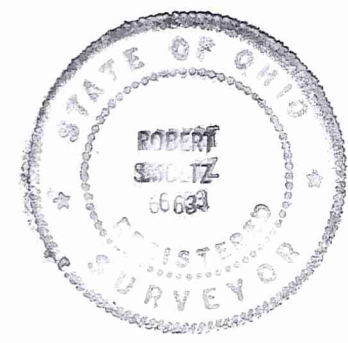

MONUMENTATION NOTES:
 All capped iron pins set are 5/8" diameter rebar, 30-inches long with a yellow plastic cap stamped SH&A 6763.
 All capped iron pins found noted as (Dudley) are 5/8" diameter, with a yellow plastic cap stamped EB Dudley PLS 6747.
 All capped iron pins found noted as (SH&A) are 5/8" diameter rebar, with a yellow plastic cap stamped SH&A 6763.

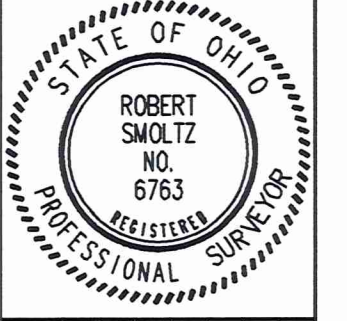
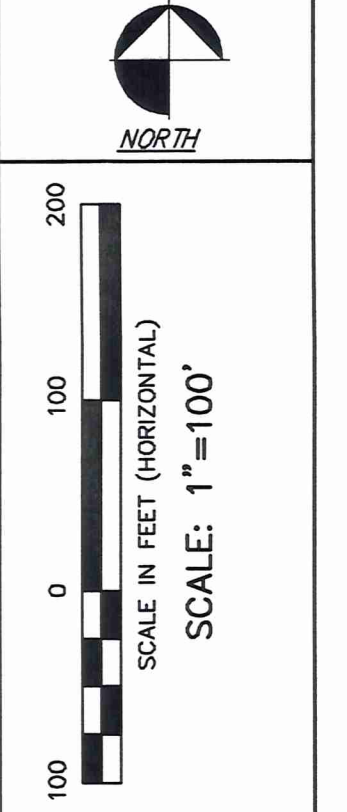

REVISIONS	DATE	DESCRIPTION
1		
2		
3		
4		
5		
6		

STEPHEN HOVANCSEK & ASSOCIATES, INC.
 CONSULTING ENGINEERS AND PLANNERS
 TWO MERIT DRIVE
 RICHMOND HEIGHTS, OHIO 44143
 PH: (216) 731-6255 FAX: (216) 731-4483

CHARDON TOWNSHIP, OHIO
PROPERTY MAP
GRILSE PARTNERS - SEARLES
PARCEL NOS. 09-001514 + 09-001539

SURVEY PLAT & LEGAL DESCRIPTION
 APPROVED PER R.C. 315.251
R.S. 10/20/08
 OFFICE OF THE REGISTERED
 GEauga COUNTY ENGINEER

DATE: 10-08-08
 JOB No. 08-131



STEPHEN HOVANCSEK & ASSOCIATES, INC. Vol. 1853-Pg. 3284

Consulting Engineers & Planners

TWO MERIT DRIVE • RICHMOND HEIGHTS, OHIO 44143

(216) 731-6255

FAX No: (216) 731-4483

**LEGAL DESCRIPTION
LAND CONVEYED FROM GRILSE TO SEARLES**

Situated in the Township of Chardon, County of Geauga and State of Ohio and known as being part of Original Chardon Township Lot No. 2 in Section No. 1, Tract No. 4 and being further bounded and described as follows:

Beginning at a drill hole monument in the center line of Little Mountain Road, 60 feet wide, and King Memorial Road, 60 feet wide; Thence North $89^{\circ}09'40''$ East, along the center line of Little Mountain Road a distance of 3736.28 feet to a P.K. nail set at the principal place of beginning of the parcel of land herein described;

Thence continuing North $89^{\circ}09'40''$ East, along said center line of Little Mountain Road a distance of 73.15 feet to a P.K. nail found at the Northwestern corner of land conveyed to Grilse Partners by deed recorded in Volume 1775, Page 1954 of Geauga County Records;

Thence South $4^{\circ}33'17''$ East, along the Westerly line of said Grilse Partner's land and passing through a 5/8-inch diameter capped iron pin found (stamped EB Dudley PLS 6747) at 30.53 feet, a distance of 625.91 feet to a capped iron pin set;

Thence North $89^{\circ}09'40''$ East, a distance of 370.74 feet to a capped iron pin set in a Westerly line of land conveyed to Robert D. and Nancy B. Searles by deed recorded in Volume 1836, Page 2483 of Geauga County Records;

Thence South $5^{\circ}24'00''$ East, along said Westerly line a distance of 159.96 feet to a 5/8-inch diameter capped iron pin found (stamped SH&A 6763) at an angle point therein;

Thence South $80^{\circ}00'00''$ West, along a Northerly line of said Searles land a distance of 360.61 feet to a 5/8-inch diameter capped iron pin found (stamped SH&A 6763) at an angle point therein;

Thence South $9^{\circ}48'12''$ East, along the Westerly line of said Searles land a distance of 284.62 feet to a 5/8-inch diameter capped iron pin found (stamped EB Dudley PLS 6747, observed 0.10 feet South) at an angle point therein;

Thence South $41^{\circ}34'44''$ East, continuing along said Westerly line a distance of 424.45 feet to a 5/8-inch diameter capped iron pin found (stamped SH&A 6763) at an angle point therein;

Thence South $70^{\circ}11'00''$ East, along the Southerly line of said Searles land a distance of 155.00 feet to a 5/8-inch diameter capped iron pin found (stamped SH&A 6763) at an angle point therein;

Thence South $57^{\circ}11'00''$ East, continuing along the Southerly line of said Searles land a distance of 170.00 feet to a 5/8-inch diameter capped iron pin found (stamped SH&A 6763) at an angle point therein;

LEGAL DESCRIPTION
PURCHASED LAND
Page 2 of 3

Thence North 46°49'00" East, continuing along said Southerly line a distance of 58.00 feet to a 5/8-inch diameter capped iron pin found (stamped SH&A 6763) at a point in the Westerly line of land conveyed to SSB Family LLC by deed recorded in Volume 1827, Page 3410 of Geauga County Records;

Thence South 21°11'56" East, along said Westerly line a distance of 254.51 feet to a 5/8-inch diameter capped iron pin found (observed 0.25 feet South) at an angle point therein;

Thence South 6°08'42" East, continuing along said Westerly line a distance of 173.06 feet to a 5/8-inch diameter capped iron pin found (stamped SH&A 6763) at a point in the Northerly line of land conveyed to Steven P. & Penelope A. Combs by deed recorded in Volume 828, Page 949 of Geauga County Records;

Thence South 85°08'55" West, along said Northerly line a distance of 702.20 feet to a 5/8-inch diameter iron pin found in the Easterly line of land conveyed to Ralph Victor Construction, Inc. by deed recorded in Volume 831, Page 1349 of Geauga County Records;

Thence North 0°07'32" East, along said Easterly line a distance of 301.20 feet to a 5/8-inch diameter iron pin found, set in concrete at the Northeasterly corner thereof;

Thence North 8°39'40" West, a distance of 332.08 feet to a capped iron pin set;

Thence North 9°48'12" West, a distance of 720.00 feet to a capped iron pin set;

Thence North 4°33'17" West, and passing through a capped iron pin set at 644.10 feet in the Southerly line of Little Mountain Road a distance of 674.16 feet to the principal place of beginning and containing 12.475 acres (543,426 square feet) of land, as surveyed by Stephen Hovancsek & Associates, Inc., in June 2008 under the direction of Robert Smoltz, Registered Surveyor No. 6763, State of Ohio, be the same more or less but subject to all legal highways.

Basis of bearings contained herein being the centerline of Little Mountain Road, established at North 89°09'40" East by the deed recorded in Volume 1775, Page 1949 of Geauga County Records and are used only to denote angles. All capped iron pins set are 5/8-inch diameter rebar, 30-inches long with a yellow plastic cap stamped SH&A, 6763.

Instruments of prior reference: Volume 1775, Page 1949 and Volume 1775, Page 1954.

Lot Split and Consolidation for Parcel Nos. 09-001514 (10.881 acres) and 09-001539 (1.594 acres).

SURVEY PLAT & LEGAL DESCRIPTION
APPROVED PER R.C. 315.251

R.S.
10/20/08
OFFICE OF THE *Revised*
GEAUGA COUNTY ENGINEER



Robert Smoltz